

# Short-form operating instructions

## METTLER TOLEDO AM/PM-balances

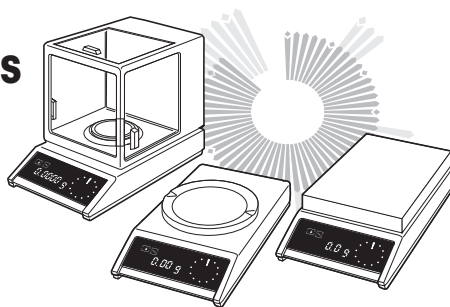

**METTLER TOLEDO**

### Switching on the display

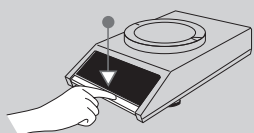

### Switching off the display

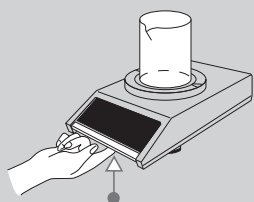

### Calibrating

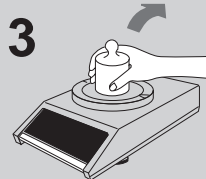
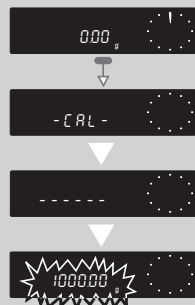
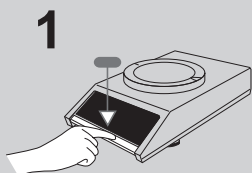

### Weighing process adapter

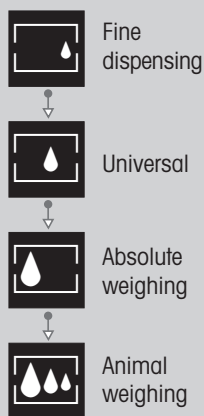
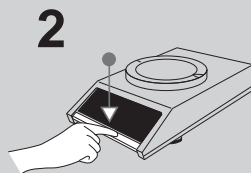
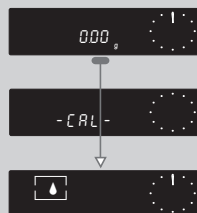
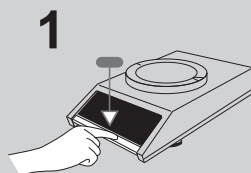

### Vibration adapter

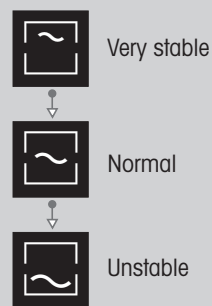
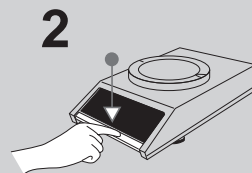
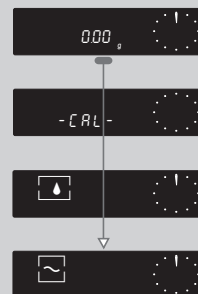
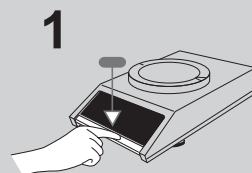

### Taring; weighing

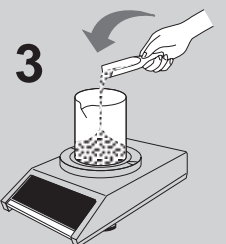
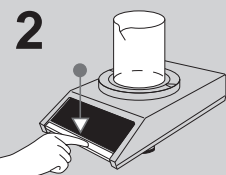
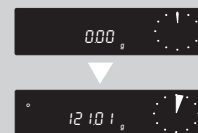
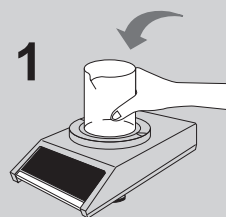

 Control bar press **briefly**

 Control bar **keep depressed** until required display appears

 Display changes automatically

**1** Step number



# Settings in the configuration file

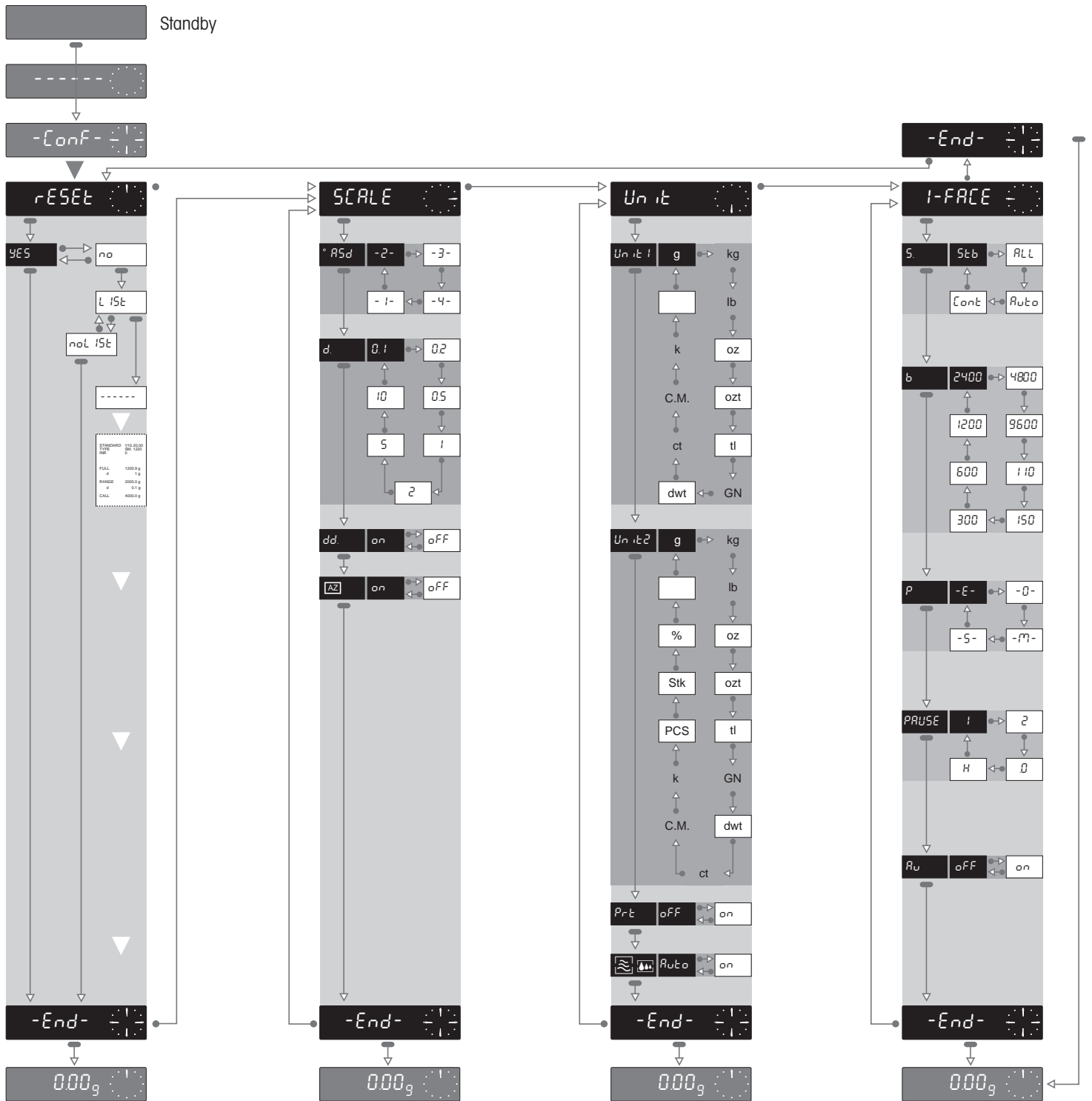

Control bar press **briefly**

Display changes **automatically**

Control bar **keep depressed** until required display appears

**°ASd** **-2-** **Standard setting**

**-3-** **Selectable setting**

**Unit 1** **kg** **Not all foreign units are setting on all balances (see booklet "Applications-Technical Data – Accessories")**

## Impprtant

Return to weighing mode **always** with control bar depressed until zero indication.

If you do not press control bar for **40 sec**, the balance will **automatisch** return to weighing mode. Modified settings will be stored.